

IDEAL BUILDING SYSTEMS Ltd.
 Copyright reserved. This Drawing & Information are the property & copyright of Ideal Building Systems Ltd. & must not be copied, reproduced or sent to a third party, either in whole or part, without written permission.

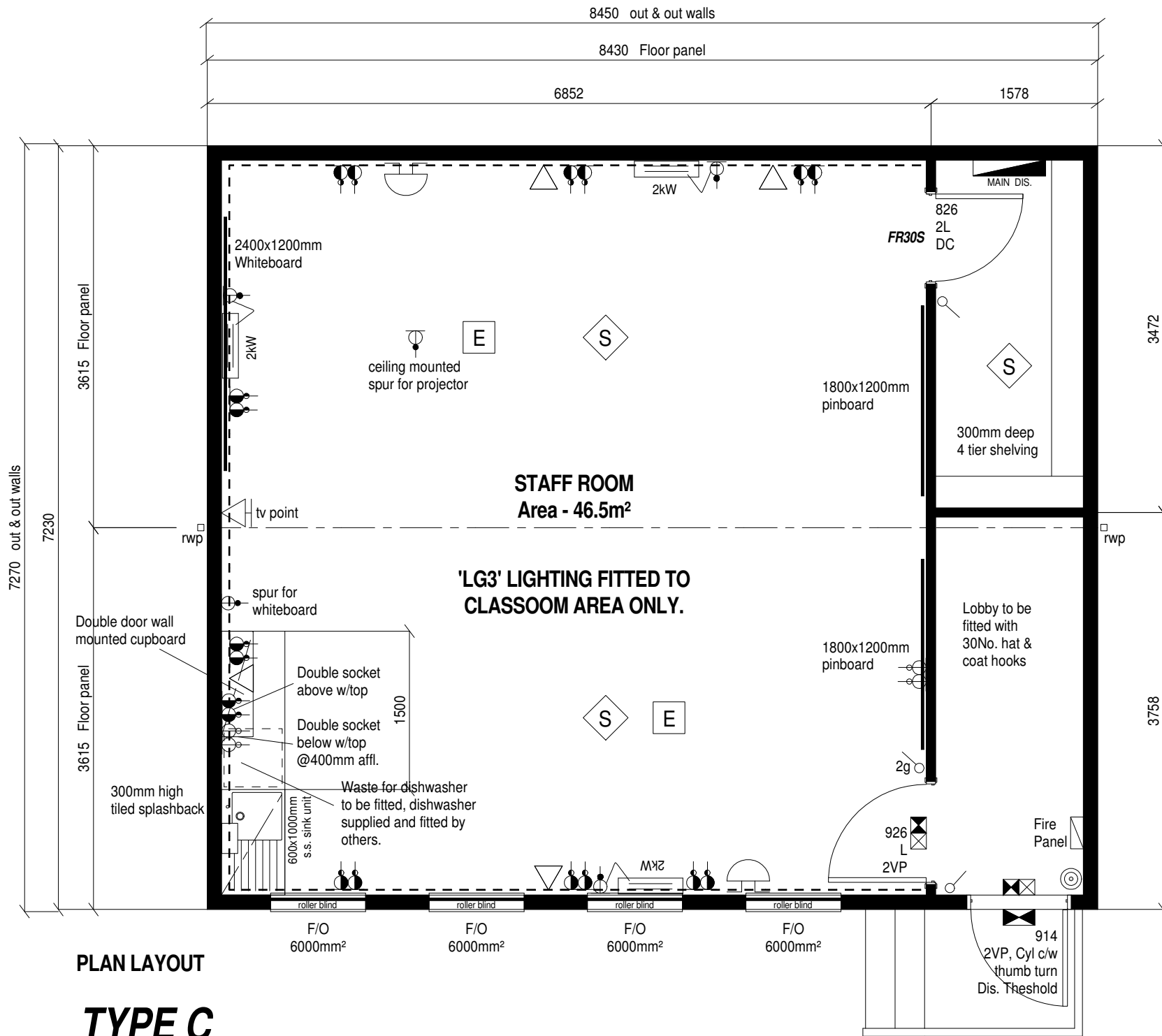

PLAN LAYOUT
TYPE C

Notes

CEILING HEIGHT 2400mm

EXTERNAL WALLS OF TEXTURED PAINT FINISH APPLIED TO HARDWOOD FACED EXTERIOR GRADE PLYWOOD GLUED AND STAPLED TO 120 x 35mm SOFTWOOD TIMBER FRAMING @ 600mm CTS SET OUT TO REDUCE THERMAL BRIDGING.

INTERNAL LINING OF 15mm 'MEGADECO', VAPOURCHECK, CREAM VINYL FACED PLASTERBOARD JOINTED BY MEANS OF TWO PART 'H' SECTIONS, WITH SET BACK BAY TO BAY JOINTS ACHIEVING ONE HOUR (NOM.) FIRE RESISTANCE IN-OUT AND CLASS '1' SURFACE SPREAD OF FLAMES.

INTERNAL PARTITIONING OF 12.5mm CREAM VINYL FACED PLASTERBOARD FIXED TO 60 x 35mm SOFTWOOD FRAMING @400mm CTS, GLASSFIBRE QUILT INSULATION TO CAVITY.

FLOOR, 15mm PLYWOOD DECKING SCREWED TO 120 x 38mm TREATED TIMBER FLOOR JOISTS @406mm CTS BOLTED TO 254mm DEEP LATTICED STEEL SKIDS @2200mm CTS. FLOOR INSULATED BY MEANS OF YBS FOIL-TEC DOUBLE ALUMINIUM REFLECTIVE FOIL INSULATION LAID OVER & DRAPED BETWEEN JOISTS WITH MINIMUM 50mm AIR GAP IN ACCORDANCE WITH MANUFACTURERS INSTRUCTIONS.

ROOF COVERING OF 'UNIROOF' SINGLE LAYER ROOFING SYSTEM FULLY BONDED TO EXTERIOR GRADE PLYWOOD DECK NAILED TO 120 x 35mm TIMBER JOISTS @400mm CTS, FIXED TO DUAL PITCH LATTICE STEEL ROOF BEAMS. CEILINGS OF 95x35mm TIMBER JOISTS @400mm CTS, UNDERDRAWN WITH WHITE DOLOMITE VINYL FACED PLASTERBOARD. ROOF SPACE VENTILATED BY MEANS OF uPVC SOFFIT VENTS. INSULATION OF 100mm THICK QUILT LAID BETWEEN JOISTS WITH A FURTHER 80mm THICK QUILT LAID PERPENDICULAR TO THE FIRT LAYER.

FASCIA OF TEXTURED PAINT FINISH APPLIED TO HARDWOOD FACED EXTERIOR GRADE PLYWOOD. RAINWATER TO DISCHARGE DIRECTLY INTO uPVC FALLPIPES AND GUTTERS.

WINDOWS WHITE uPVC DOUBLE GLAZED WITH 'PILKINGTON K' (LOW E) GLASS, FITTED WITH LOCKING COCKSPUR HANDLES, 6000mm² TRICKLE VENTS AND RESTRICTED FRICTION HINGES. TOV - 900 x 1100mm FULLY OPENING FITTED WITH ROLLER BLIND (BLACKOUT). CILL HEIGHT - 1000mm AB. FFL.

ENTRANCE DOOR TO BE 914 x 1981mm SOLID CORE PLY. FLUSH c/w 600 x 725mm TOP VISION PANELS AND 600 x 650mm BOTTOM VISION PANELS FITTED WITH ALL RELEVANT IRONMONGERY. ALUMINIUM DOOR FRAME c/w DISABLED THRESHOLD.

INTERNAL DOORS SOLID CORE PRE-FINISHED BLONDE OAK FITTED WITH RELEVANT IRONMONGERY.

NOTE:
 FLUSH JOINTS TO ALL INTERNAL WALL AND PARTITION BAY JOINT CONNECTIONS.



building systems ltd

Tel 01262 606750
 Fax 01262 671960

Client **BERKELEY CONSULTANCY**
 Title **PROPOSED TWO BAY 8.4 x 7.2m MODULAR SINGLE CLASSROOM ACCOMMODATION - PLAN LAYOUT**

Revisions
A: SINK, WORKTOP, WATER HEATER ADDED. 25/01/06 MAH

DRAWN	MAH
SCALE	1:50
DATE	27 / 10 / 05
DRG No.	13000 - 7

ORIGINAL DRAWING PAPER A3